

Christmas Tree Panel REA Instructions

You will need:

6" x 10" scrap of medium brown fabric
4" square of light brown fabric
5" square of dark brown fabric
¼ yard of yellow/gold fabric
¼ yard of red fabric
¼ yard of purple fabric

¼ yard of med green fabric
¼ yard of dark green fabric
½ yard of light green fabric.
2 yards of background fabric
2 yards of backing fabric

I am using my quilt as a wall hanging, I am not going to put fusible on the back of all my fabrics. If you are going to use it as a quilt or believe it will get a lot of handling, you may want to put a light weight fusible on the backs of all the applique fabrics. If you use any lame', satin, or stretchy fabrics, you will want to put a light weight fusible or lightweight fusible interfacing on the back of these types of fabrics both for stability and raveling.

The Christmas Tree itself finishes at 26" x 54". I loaded backing and batting that was 44" wide by 72" long (WOF x 2 yards). I pinned the short (wof) sides to the take-up rollers. We are going to start at the bottom of the tree and work towards the top so that if your backing and/or background fabric is directional, you'll want to pin the bottom of the fabric to the top take-up roller. Place your background fabric on top of the backing and batting and baste across the top and down the sides.

First, we are going to quilt the background. I am using pattern: Christmas 2012 pano 001. Quilt as you would normally quilt an edge to edge pattern.

Once you have the entire piece of background fabric quilted, roll the quilt back to the top. We want to have at least 4" of plain quilted fabric above the applique tree.

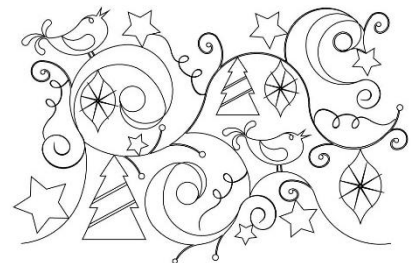

Set up your system to stop at jump stitches, set your spi to at least 14, turn on your crosshairs and load the Christmas tree panel pass 1. Center the pattern on the background fabric as shown.

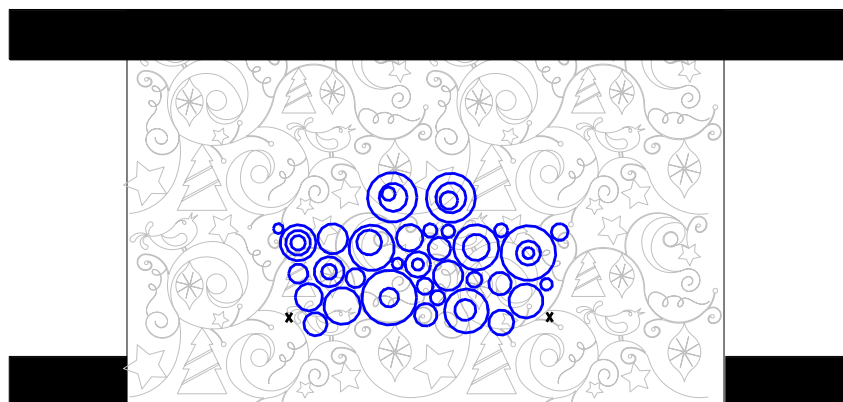

Notice that this pattern has registration marks (the little x's). We are going to use these for aligning each pass. It is too difficult to find relocation points when we are only quilting circles, 😊.

Here is the Stitch map (the order of stitching for the 1st pass:

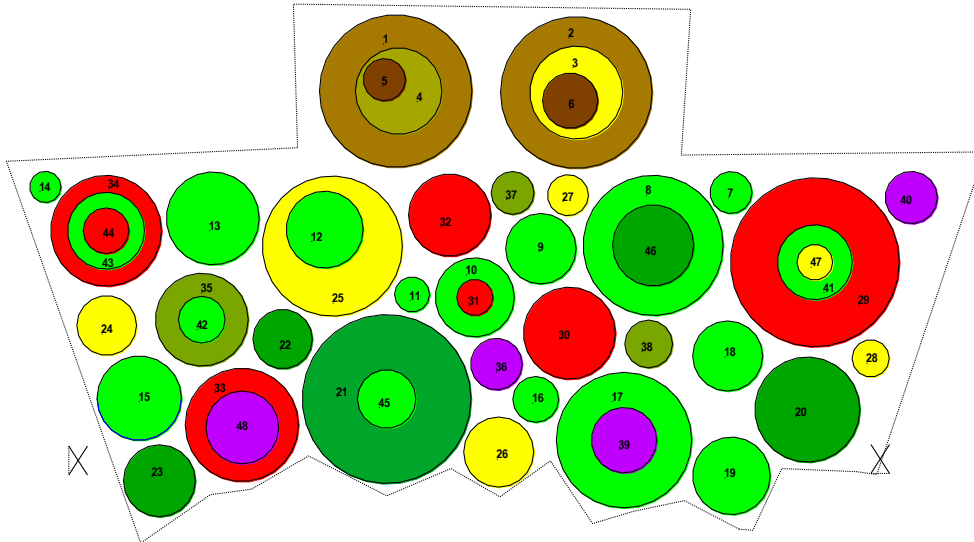

Left registration mark

Right registration mark

1-2: medium brown

3: yellow/gold

4: light brown

5-6: dark brown

7-19: light green

20-23: dark green

24-28: yellow/gold

29-34: red

35-37: medium green

38-40: purple

42-43: light green

44: red

45: LIGHT GREEN

46: DARK GREEN

47: YELLOW GOLD

48: PURPLE

Note: The number 49 & 50 are not used.

You will use basic raw edge applique techniques: lay down the fabric, use your crosshairs to make sure that the entire area to be stitched has fabric covering it, stitch down the fabric. Trim away the excess fabric and move to the next circle. Once the pass is finished, roll the quilt, making sure that the registration marks are accessible.

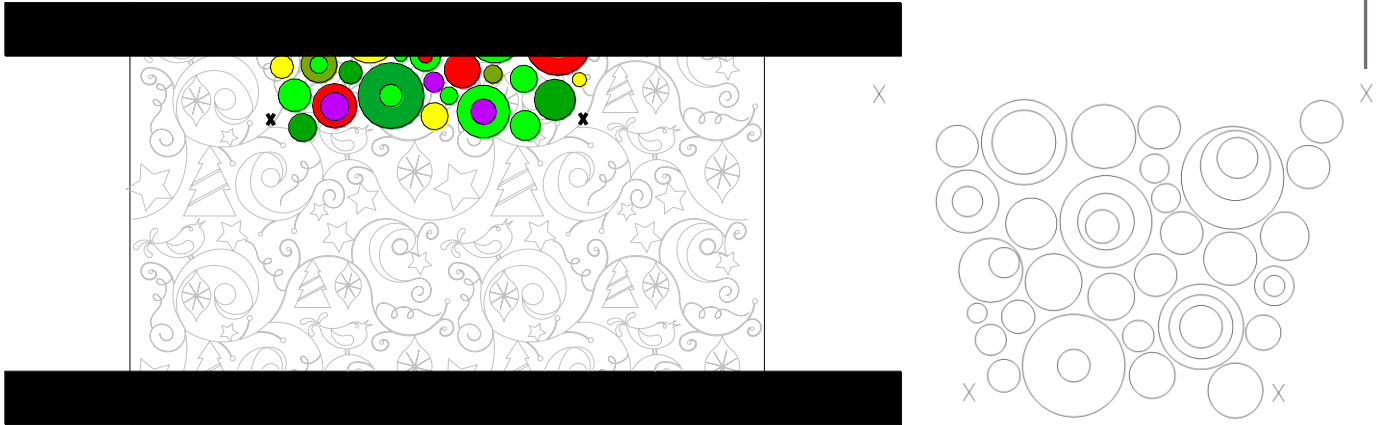

Here is the pattern for the second pass, notice the registration marks that are floating at the top of pattern. These registration marks match up to the registration marks that we stitched out in the first pass. Using the crosshairs or pins (whatever your system uses for alignment) on your system line up the pattern to the previous row. You may need to adjust the size and rotation.

I personally did not want the double stitch the registration marks so once everything was aligned, I remove the top 2 registration marks before stitching out the pass.

Here is the Stitch map (the order of stitching for the 2nd pass:

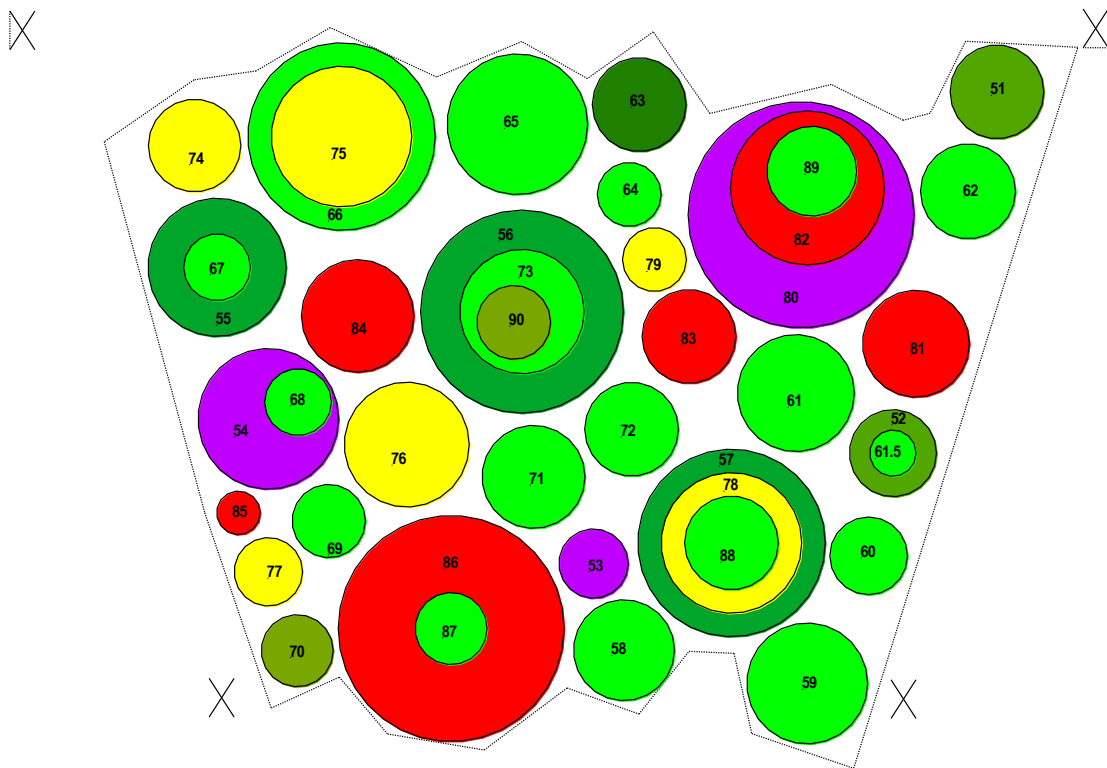

Top Left registration mark

Top Right registration mark

52-52: medium green

53-54: purple

55-57: dark green

58-62: light green

63: dark green

64-69: light green

70: medium green

71-73: light green

74-79: yellow/gold

87-89: light green

90: medium green

Lower left registration mark

Lower right registration mark

Once the pass is finished, roll the quilt, making sure that the lower registration marks are accessible.

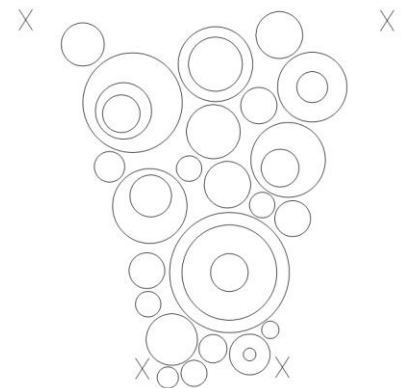

Here is the pattern for the third pass, notice the registration marks that are floating at the top of pattern. These registration marks match up to the registration marks that we stitched out in the second pass. Using the crosshairs or pins (whatever your system uses for alignment) on your system line up the pattern to the previous row. You may need to adjust the size and rotation.

I personally did not want the double stitch the registration marks so once everything was aligned, I remove the top 2 registration marks before stitching out the pass.

Here is the Stitch map (the order of stitching for the 3rd pass:

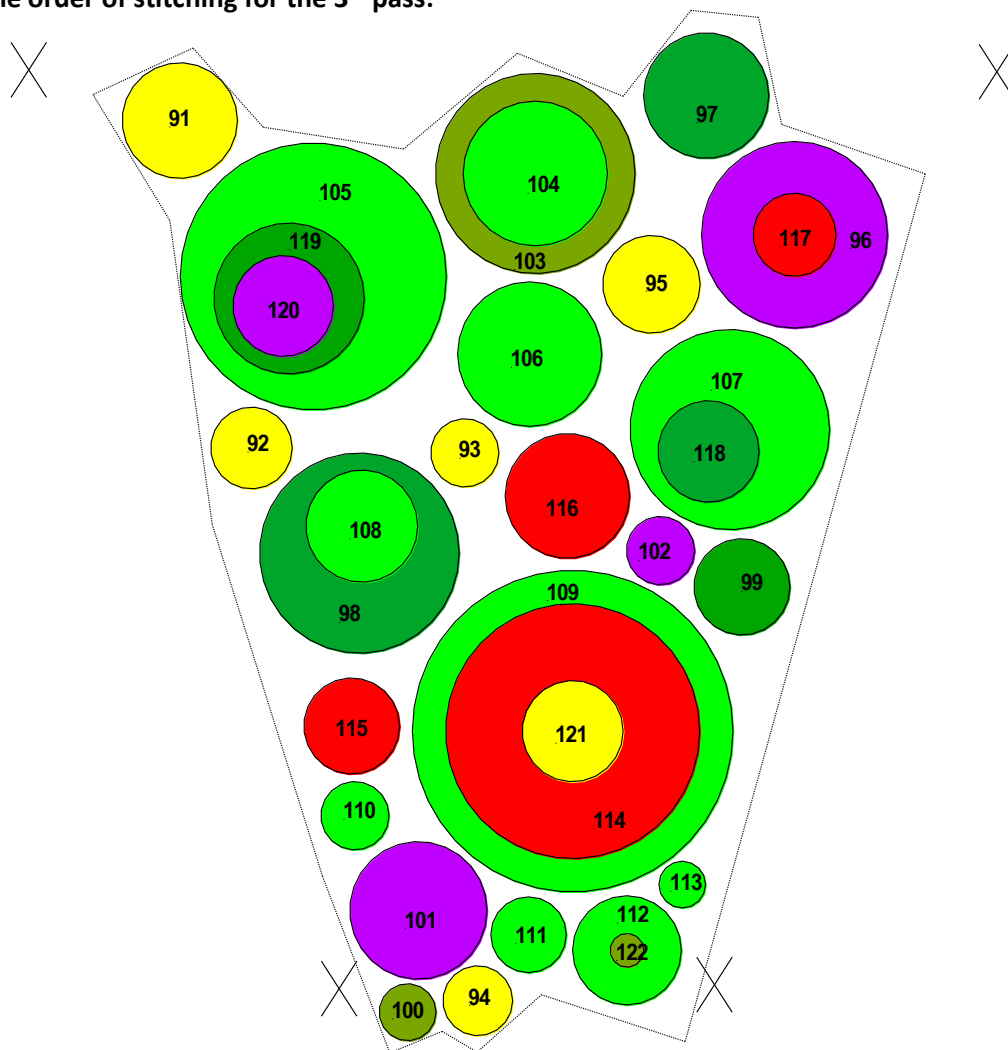

Top Left registration mark

Top Right registration mark

96: purple

97-99: dark green

101-102: purple

103: medium green

104-113: light green

114-117: red

118-119: dark green

120: purple

121: yellow/gold

122: medium green

Lower left registration mark

Lower right registration mark

Once the pass is finished, roll the quilt, making sure that the lower registration marks are accessible.



Here is the pattern for the fourth pass, notice the registration marks that are floating at the top of pattern. These registration marks match up to the registration marks that we stitched out in the third pass. Using the crosshairs or pins (whatever your system uses for alignment) on your system line up the pattern to the previous row. You may need to adjust the size and rotation.

I personally did not want the double stitch the registration marks so once everything was aligned, I remove the top 2 registration marks before stitching out the pass.

Here is the Stitch map (the order of stitching for the 4th pass:

- 122-124: dark green
- 125- medium green
- 126-128: light green
- 129: medium green
- 130: light green
- 131: red
- 132: purple
- 132-134: yellow/gold

Remove from machine, trim to desired size, and bind.

